

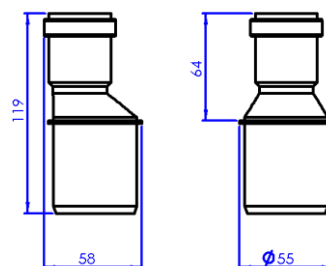

Made in Italy

# OUTLED 32

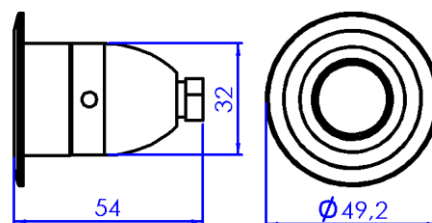

Outercasing

## Description:

OUTLED 32 is a recessed waterproof LED projector design to be installed on the floor, wall or ceiling. It has a circular form and an aluminium alloy body.

**Applications:** General lighting of outdoor and indoor areas, gardens, plants and walkways.



## On demand:

- Outercasing for the product.

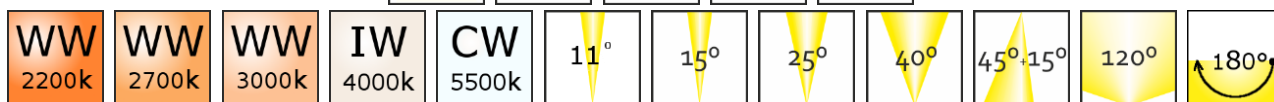
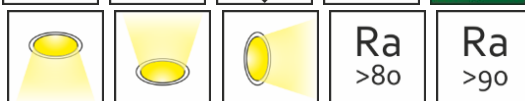



Made in Italy

# OUTLED 32

## Specifications:

### Nominal power:

- 350mA 1,0W
- 500mA 1,5W
- 700mA 2,1W

### Colour temperature options:

- Warm white 2200°K 100..175L **A++**
- Warm white 2700°K 120..220L **A++**
- Warm white 3000°K 135..280L **A++**
- Natural white 4000°K 135..280L **A++**
- Cold white 5500°K 120..220L **A++**

### Secondary optics options:

- Optics with a narrow beam 11°
- Optics with a narrow beam 15°
- Optics with a narrow beam 23°
- Optics with an average beam 38°
- Optics with a wide beam 120°
- Optics with an asymmetry beam
- Side protection

### Projector body:

- Alumimun alloy

### Finish:

- Anodized aluminum
- Bright or colored anodization (on demand)

Note: All the data above are typical and can change without notice

### Cover glass:

- Transparent glass
- Opaque tempered glass

### Connection:

- Neoprene cable 2x0,75 600mm.

### International protection

#### Marking:

- IP67

### Power supply:

- CC 350..700 mA driver not included

### Polarity:

- Brown or red positive +
- Blue or black negative -

### Tipologia di collegamento:

- CC 350/700mA Series connection

### Other technical features:

- Insulation class III
- Walkable
- The product was manufactured in compliance with the EN 62471:2009 standards , risk-free

## Additional note for the installation:

- OUTLED 32 cannot be installed in areas where water heavily stagnates and it must never go completely underwater.
- For a proper installation, the projector must have a drainage system under the outercasing.
- PLEASE PAY ATTENTION. If the cable is repositioned, check the efficiency of the seal on the cable gland.

## Power supply:

Power supply	Nr.min/max. Projectors	Type	Code	Note
350mA	3/15	Encapsulated	LD220350.20r	
350mA	6/25	Standard	LD23035.20	
500mA	5/12	Standard	LD23050.20	
350/500/700mA	12/12/6	Dimming	LD220350.15dim	



Made in Italy

# OUTLED 32

## Photometric diagrams:

The diagrams are valid only with projectors with a transparent cover glass power supplied with 500 mA and with 205 Lumen

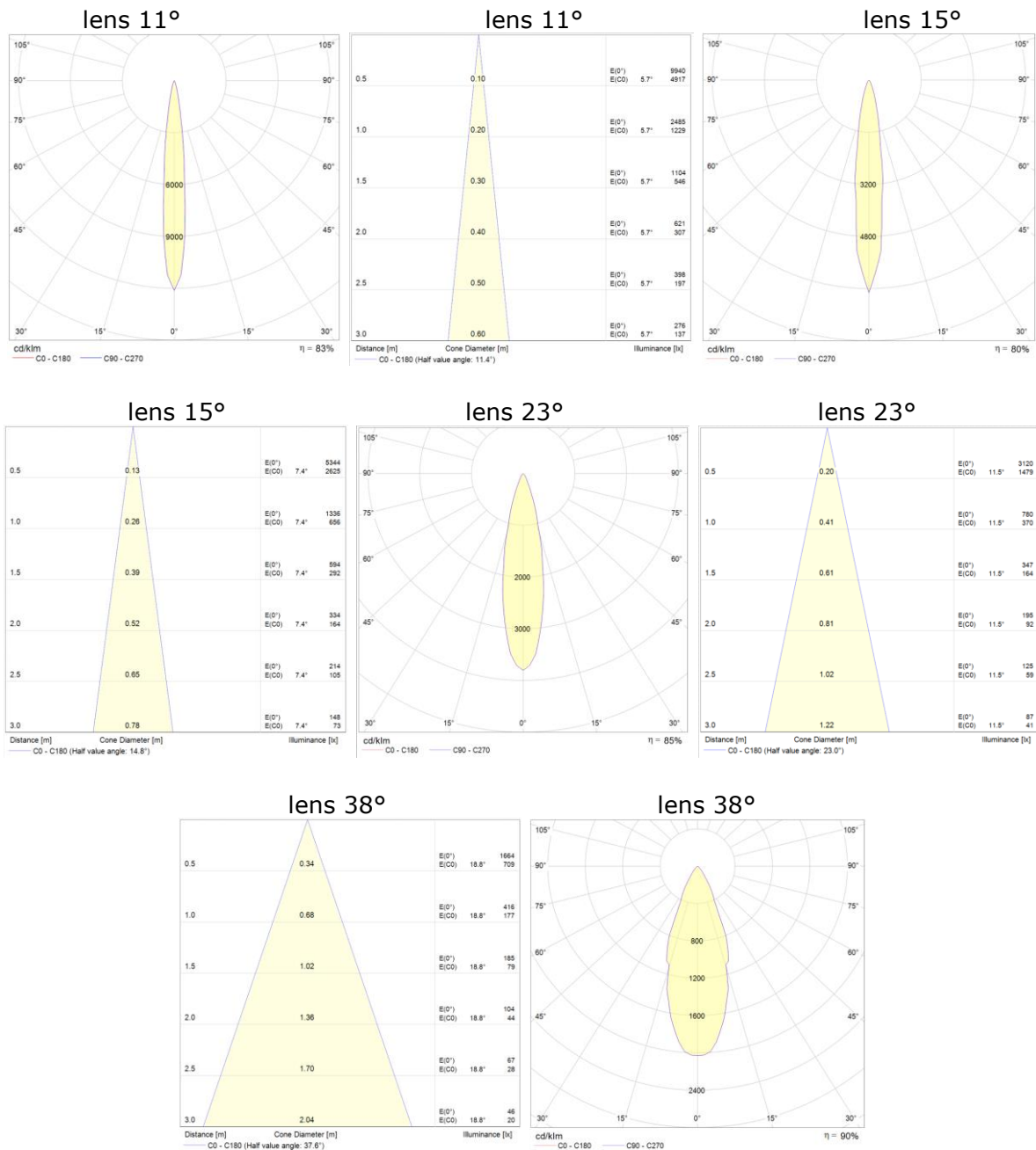

The data shown is indicative; there may also be some differences depending on the power supply used.

Co.E.M. srl reserves the right to improve the product in terms of performance and manufacturing without any obligations of prior communication to the client. Release 1.3 2017